

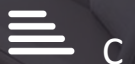

17 Berkeley Street

Mayfair, W1J 8EA

£1,600 Per Week



Floor Plan

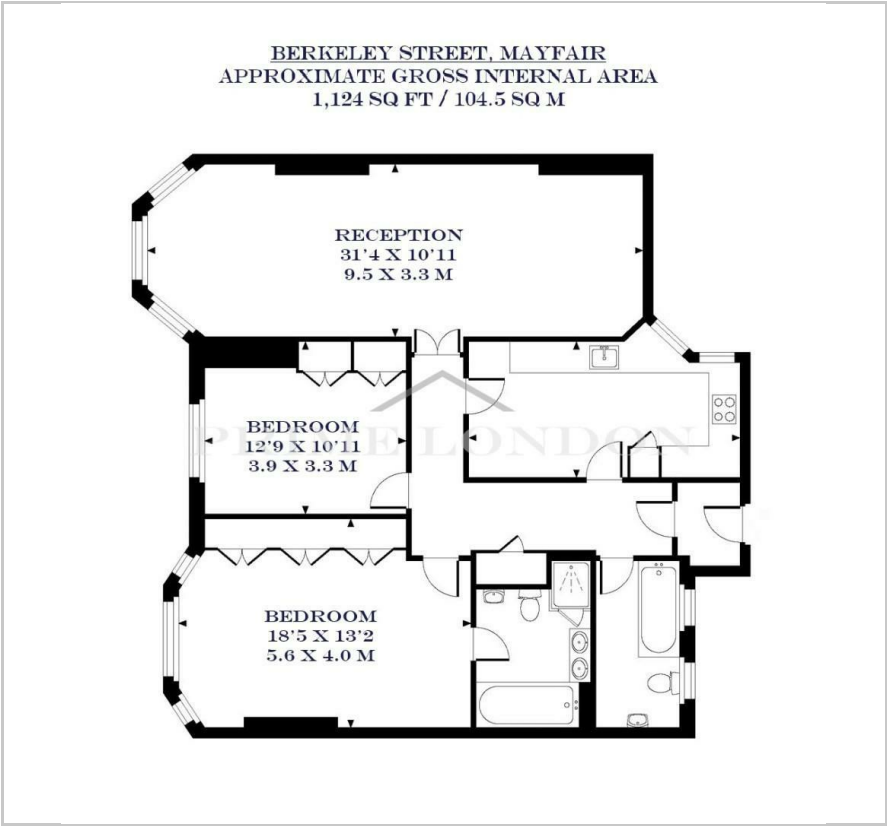

Area Map



Energy Efficiency Graph

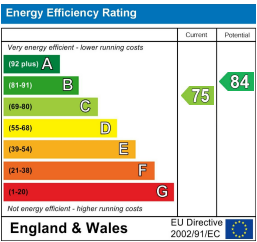

Viewing

By appointment. Contact us on 0207 052 1075 if you wish to arrange a viewing appointment for this property, or require further information.

- Two bedroom apartment in 1,124 sq ft (104.5 sqm) the heart of Mayfair
- Large kitchen with space for dining
- Period features and high ceilings throughout
- Short walk to Piccadilly Circus
- Porter and lift access and the West End

This fantastic two bedroom apartment, located in a well maintained building in Mayfair, is available for lease through Prime London.

Totalling 1,124 sq ft (104.5 sqm), this property boasts a large reception area with high ceilings, a separate fully integrated kitchen with space for dining. Additionally, it offers a master bedroom with built-in wardrobes and en en-suite bathroom that includes both a bath and a separate shower, a second double bedroom and a family bathroom.

Located in Mayfair, Berkeley Street runs south from Berkeley Square to Piccadilly, conveniently close to Green Park tube station, which serves the Piccadilly, Victoria, and Jubilee lines.

The amenities of Piccadilly Circus and the West End are within walking distance, as are the expansive open spaces of Green Park and Hyde Park, all within 0.5 miles of the property.



These particulars, whilst believed to be accurate are set out as a general outline only for guidance and do not constitute any part of an offer or contract. Intending purchasers should not rely on them as statements of representation of fact, but must satisfy themselves by inspection or otherwise as to their accuracy. No person in this firms employment has the authority to make or give any representation or warranty in respect of the property.